



**SVK**  
**& SVS**  
**AUDIO**  
**SERIES**  
**MULTIPIN**  
**CONNECTORS**

***syntax***  
***no compromise***

## INLINE FEMALE



The new **SYNTAX® SVK** audio series has been conceived and manufactured to set a higher standard for studio applications. Its IP67 waterproof rating makes it perfectly suitable also for outdoor applications. **SVS** Slim High-Density series is also available (72 and 101 pin configurations). **SVK** audio and **SVS** Slim High Density series are compliant with military standard Mil C 5015 & VG 95234. Compared to our previous standard audio series, the new SVK has been enhanced to achieve a higher level of robustness and durability.



Special aluminium alloy shell with high-resistance black finish.

Pic. 1 - Marked knurling on the whole circumference of locking-ring for optimal grip and easy coupling. An audible click indicates that locking is complete.

Pic. 2 - Thick wall construction locking-ring for greater resistance to all possible forms of abuse.

Pic. 3 - The aluminium housing for the neoprene insert is flush with the edge of locking-ring, so to avoid ovalization due to accidental blows.

Pic. 4 - Extra wide backshell for easier wiring.

Increased size of Coupling roller pins on locking-ring for more durability.

## INLINE MALE



Many of its features have been borrowed from the bigger SHD Roadline series, such as a thicker locking ring with deeper knurling for maximum ease of coupling and a thicker backshell. The new aluminium locking ring also features coupling roller pins and, just like on the SHD series, the locking ring is designed in such a way to prevent possible ovalization of the insert due to accidental blows. Protective dust caps are available. They are provided with a special high-resistance cable lacing made up of seven stainless strands, covered by an anti-abrasion Teflon black tube.

**SVK** audio is available in 13, 19, 25, 37, 54, 85, 100 and 150 pin configurations.

**SVS** Slim High-Density series is available in 72 and 101 pin configurations.

## DUST CAP FOR IP67 WHEN MATED

Version for  
female  
connector



Version for  
male  
connector



# SVK AUDIO 13 - 19 - 25 - 37 - 54 - 72 - 85 - 100 - 101 - 150 PIN & SVS



**PANEL FEMALE**



**PANEL MALE**

## CONTACTS

### CRIMP CONTACTS TYPES AND PART N.

Size	Connector	Plating	Part N.	Gender	Part N.	Gender
16	13/19/25/37/54/85 pin	Silver	SVKP16SFC	Female	SVKP16SMC	Male
		Gold	SVKP16GFC	Female	SVKP16GMC	Male
18	100/150 pin	Gold	SVKP18GFC	Female	SVKP18GMC	Male
20	72/101 pin	Gold	SVKP20GFC	Female	SVKP20GMC	Male

### SOLDER CONTACTS TYPES AND PART N.

Size	Connector	Plating	Part N.	Gender	Part N.	Gender
16	13/19/25/37/54/85 pin	Gold	SVKP16GFS	Female	SVKP16GMS	Male

### CONTACTS RATING

Size	Max Current	Rated Current	Max Voltage Drop	Wire section (mm <sup>2</sup> )	Wire section AWG
16	22 A	13 A	74 mv	1+1,5	18+16
18	10 A	7,5 A	83 mv	0,15+0,6	26+20
20	7,5 A	7,5 A	83 mv	0,15+0,3	26+22

### CONNECTORS RATING

Contacts number	Operating voltage		Test voltage	Min. Flashover
	Vdc	Vac	Vac	Vac
13/19/25/150 - 72/101	250	200	1000	1400
37/54/85/100	700	500	2000	2800

## OVERALL SIZE

## CUT-OUT DIMENSIONS

### PANEL FEMALE

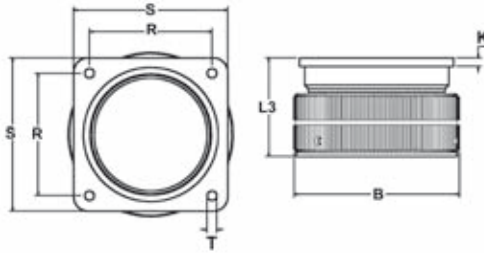

N° pin	shell size	BØ Max	L3	K	R	S	T
			Max	±0.2	±0.1	±0.3	H13
13 - 19	20	43.0	38.1	4	29.4	38.0	3.2
25	24	50.4	40.6	4	34.9	44.5	3.7
37-72	28	56.0	40.8	4	39.7	50.8	3.7
54-101	32	63.0	43.7	4	44.45	57.0	4.4
85-100-150	40	75.0	44.8	4	55.6	69.8	4.4

### PANEL MALE

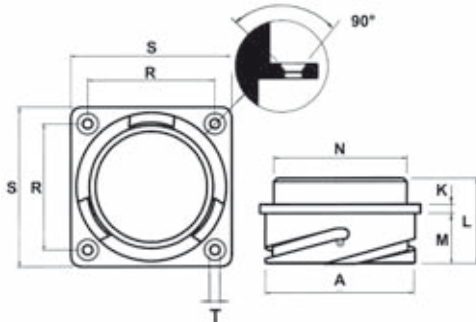

N° pin	shell size	AØ	K	L	M	ØN	R	S	T
		+0/-0.15	±0.2	±0.3	±0.4/-0	Max	±0.1	±0.3	H13
13 - 19	20	34.2	4	34.5	19	31.75	29.4	38.1	3.2
25	24	40.9	4	35.7	20.6	35.3	34.9	44.5	3.7
37-72	28	46.7	4	35.7	20.6	41.4	39.7	50.8	3.7
54-101	32	53.4	4	37.3	22.2	47.8	44.5	57	4.3
85-100-150	40	65.5	4	37.3	22.2	59	55.6	69.8	4.3

### INLINE FEMALE

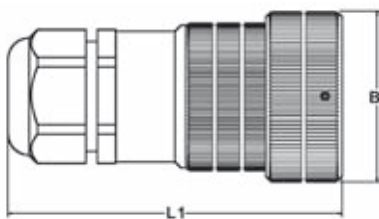

N° pin	shell size	BØ Max	L1 Max	Cable clamp Metric	Ø cable Min.-Max.
13 - 19	20	43.0	103	M 20	6 - 14
25	24	50.4	108	M 25	6 - 18
37-72	28	56.0	116	M 32	7 - 25
54-101	32	63.0	121	M 32	7 - 25
85 - 100 - 150	40	75.0	147	M 40	15 - 32

### INLINE MALE

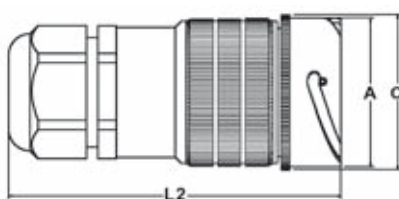

N° pin	shell size	AØ Max	ØC	L2 Max	Cable clamp Metric	Ø cable Min.-Max.
		+0/-0.15	Max			
13 - 19	20	40.0	43	102	M 20	6 - 14
25	24	40.9	44	109	M 25	6 - 18
37-72	28	46.7	50	116	M 32	7 - 25
54-101	32	53.4	56	122	M 32	7 - 25
85 - 100 - 150	40	65.5	69	147	M 40	15 - 32

### 13/19 pin

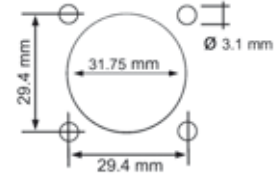

### 25 pin

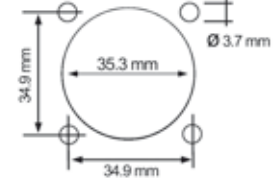

### 37/72 pin

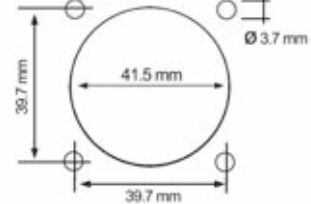

### 54/101 pin

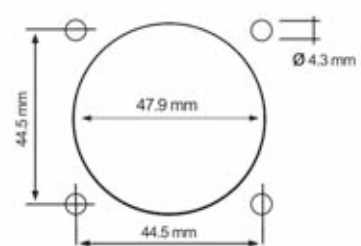

### 85/100/150 pin

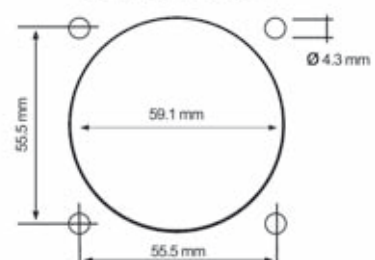

# INSERT LAYOUTS AND WIRING LIST

## FRONT VIEW OF MALE INSERT

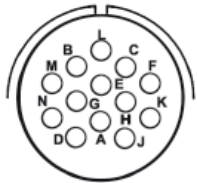

13 pin / size 20

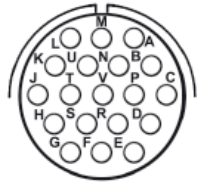

19 pin / size 20

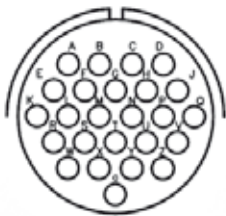

25 pin / size 24

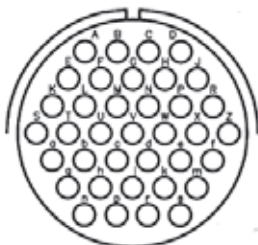

37 pin / size 28

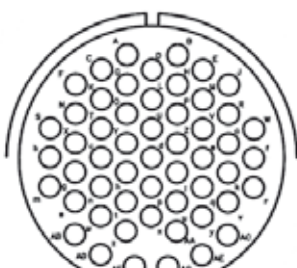

54 pin / size 32

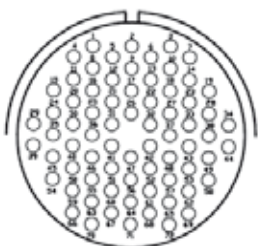

72 pin / size 28

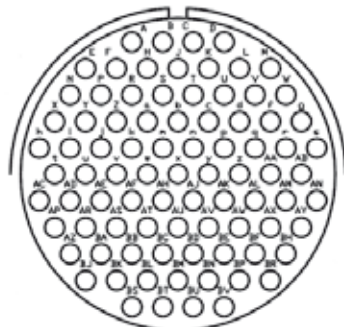

85 pin / size 40

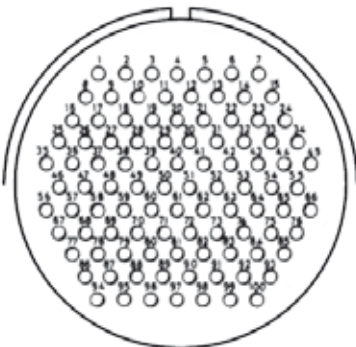

100 pin / size 40

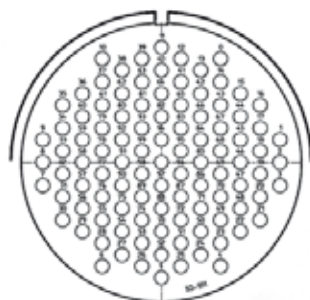

101 pin / size 32

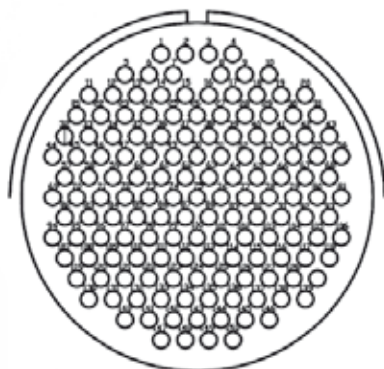

150 pin / size 40

13 pin - 4 channels			
Ch	Hot	Cold	Gnd
No.	+	-	⏏
1	M	B	L
2	N	G	E
3	D	A	H
4	J	K	F

19 pin - 6 channels			
Ch	Hot	Cold	Gnd
No.	+	-	⏏

# PART NUMBER EXPLANATION

Part N.

EXAMPLE Part N. **SVK 150 F V R G S MP N**

CONNECTOR SERIES	
SVK = (13 - 19 - 25 - 37 - 54 - 85 - 100 - 150 pin) Back shell: standard. Locking ring: ergonomic and rubber coated	<b>SVK</b>
SVS = (72 - 101 PIN) slim series, high density. Back shell: standard. Locking ring: ergonomic and rubber coated	<b>SVS</b>

CONTACTS NUMBER	
013 - 019 - 025 - 037 - 054 - 072 - 085 - 100 - 101 - 150	...

CONTACT TYPE	
M = male	<b>M</b>
F = female	<b>F</b>

CONNECTOR TYPE	
V = inline	<b>V</b>
P = panel	<b>P</b>

COUPLING TERMINATION	
- = with ramps	<b>-</b>
H = ergonomic locking ring with improved thickness and stronger roller pins	<b>H</b>
R = rubber coated locking ring	<b>R</b>

CONTACT PLATING TYPE	
S = silver (13 - 19 - 25 - 37 - 54 - 85 pin)	<b>S</b>
G = gold (13 - 19 - 25 - 37 - 54 - 72 - 85 - 100 - 101 - 150 pin)	<b>G</b>
N = no contact	<b>N</b>

CONTACT TERMINATION	
C = crimp	<b>C</b>
S = solder	<b>S</b>
P = pcb	<b>P</b>
N = no contact	<b>N</b>

CABLE CLAMP RANGE - METRIC				
Thread Size	Clamping Range (mm)	SVK (pins)	SVS (pins)	
M 20 x 1.5	6 - 12	13 - 19		<b>MH</b>
M 20 x 1.5	10 - 14	13 - 19		<b>MI</b>
M 25 x 1.5	6 - 13	25		<b>MJ</b>
M 25 x 1.5	13 - 18	25		<b>ML</b>
M 32 x 1.5	7 - 15	37 - 54	72 - 101	<b>MN</b>
M 32 x 1.5	11 - 21	37 - 54	72 - 101	<b>MM</b>
M 32 x 1.5	18 - 25	37 - 54	72 - 101	<b>MO</b>
M 40 x 1.5	15 - 23	85 - 100 - 150		<b>MQ</b>
M 40 x 1.5	19 - 28	85 - 100 - 150		<b>MP</b>
M 40 x 1.5	22 - 32	85 - 100 - 150		<b>MR</b>

CABLE CLAMP TYPE	
N = normal	<b>N</b>
S = spiral flex	<b>S</b>
R = strain relief	<b>R</b>

SPECIAL VERSION (upon request)	
For example: T = inserted solder termination contacts	<b>T</b>

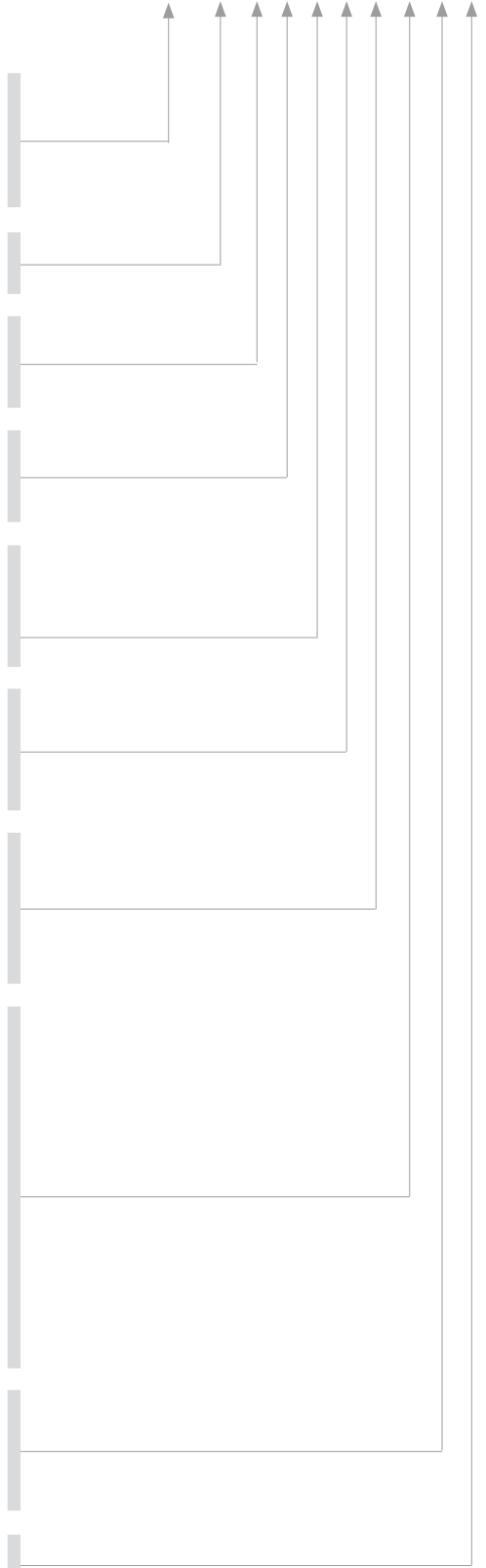

# VALENTINI

www.syntaxnet.it  
info@syntaxnet.it  
Tel. +39 0119594160  
Fax +39 0119594166  
via Asti 84/A  
10098 Rivoli  
(TO) - ITALY

**SYNTAX**<sup>®</sup>  
is a VALENTINI Trade Mark

